

# MINOM Plus

## Smart Pet Water Purifier

User Manual

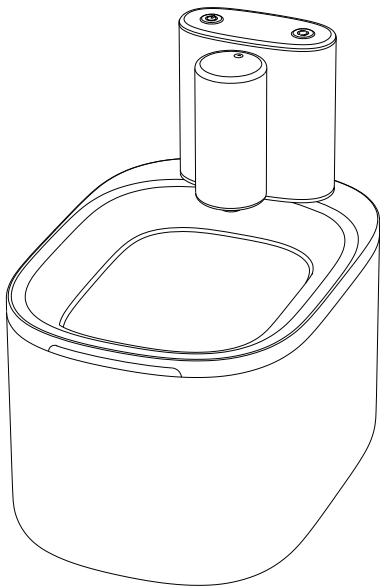

# CONTENTS

---

<b>Safety Precautions</b>	<b>01</b>
<b>Product Overview</b>	<b>02</b>
<b>Assembling the Device</b>	<b>04</b>
<b>Status Indicators and Buttons</b>	<b>07</b>
<b>Operating the Device</b>	<b>09</b>
<b>Battery Management</b>	<b>10</b>
<b>Smart Motion Sensor</b>	<b>11</b>
<b>Filter Replacement</b>	<b>12</b>
<b>Cleaning and Maintenance</b>	<b>13</b>
<b>Specification</b>	<b>13</b>
<b>Smartphone Application</b>	<b>14</b>
<b>Troubleshooting</b>	<b>20</b>
<b>FCC Statement</b>	<b>21</b>
<b>Warranty</b>	<b>22</b>

## **SAFETY PERCAUTIONS**

### **! Warning**

- Dispose all packaging materials properly. Keep the polybags away from children and pets as these bags could cause suffocation.
- DO NOT place any foreign objects in the water tank.
- DO NOT use the device for anything other than its intended use.
- Only use accessories recommended by the manufacturer. The use of accessories other than the recommended specifications may cause unsafe conditions.
- DO NOT modify the device.
- DO NOT operate the device if the unit is malfunctioning or has been damaged. Do not attempt to repair on the device. Contact our customer service immediately for further instructions.
- Disconnect the power supply when the device is not in use.
- Disconnect the power supply before cleaning the device.
- The power adapter and the cable must never get wet.
- This product is for indoor use only
- This product is should not operate without water.
- DO NOT use the device in the bathroom.

### **CAUTION**

- DO NOT allow pets to chew any parts of the device. If you are concerned regarding the power cord, purchase a cord conduit to protect the power cord.
- If an extension cord is necessary, one unit with a proper rating can be use.
- DO NOT install or store the device where it will be expose to weather or temperatures below 0°C / 40°F.
- To maintain compliance with FCC's RF Exposure guidelines, this device should be place with a minimum distance of 20cm from your body.

## PRODUCT OVERVIEW

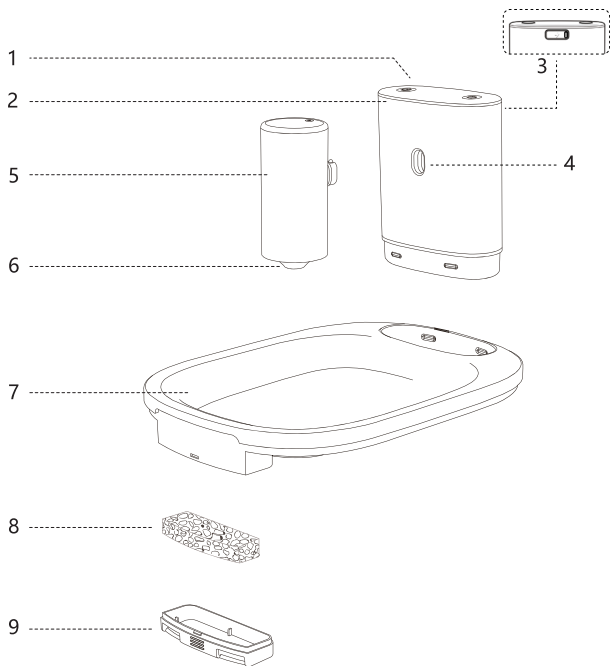

1) Control Panel

4) Port for Cartridge

7) Water Tray

2) Control Hub

5) UF Filter Cartridge

8) Foam Filter

3) Charging Port

6) Water Outlet

9) Filter Compartment

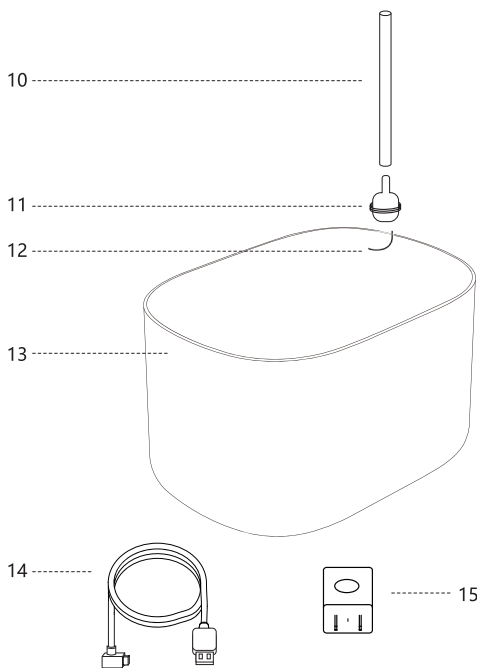

10) Water Pipe

12) Spherical Filter

14) Type-C Cable

11) Water Inlet

13) Water Tank

15) Adapter

## ASSEMBLING THE DEVICE

1. Install the UF Filter Cartridge to the Control Hub.

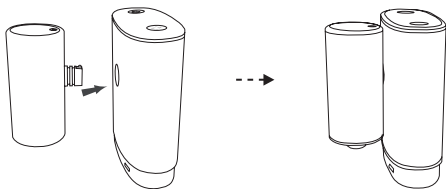

2. Attach the soft water pipe underneath.

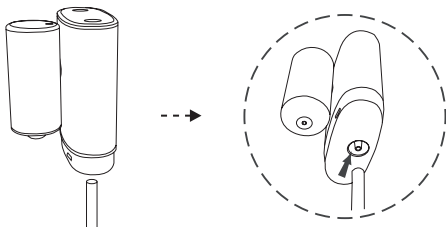

3. Attach the water inlet and the spherical filter to the pipe.

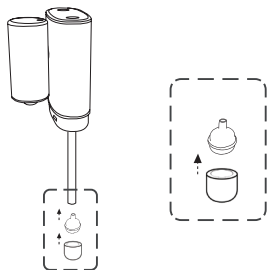

4. Place the foam filter in the filter compartment and attach the compartment to the water tray. (Press and pull down to remove the filter compartment)

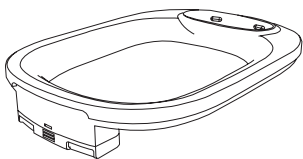
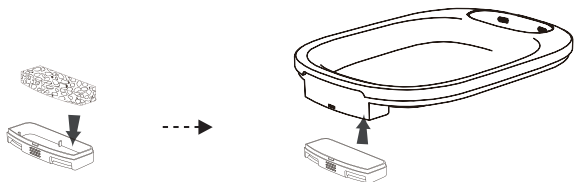

5. Pour water in the water tank.

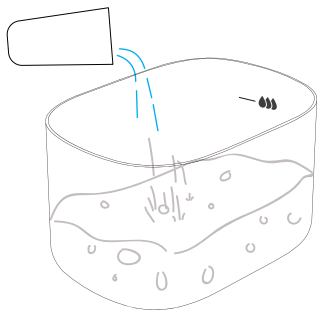

**Note**

Do not exceed the maximum water.

6. Place the water tray on the water tank.

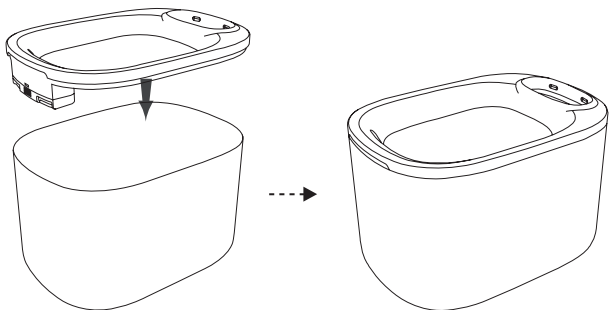

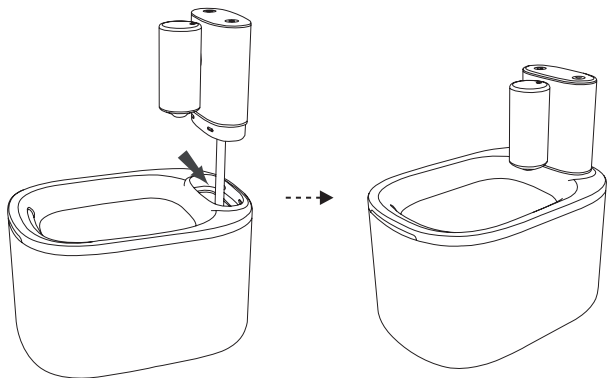

7. Place the Control Hub on the water tray.



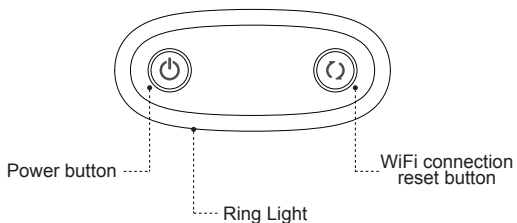

## STATUS INDICATORS AND BUTTONS



### Status Indicators

Ring Light Movement	Indicator	Status
 Back to Front	Flashing blue color	Charging
	Constant blue color	Fully Charged
 Front to Back	Flashing blue color	When the motion sensor detects movement, the device dispenses water.

## Buttons

Icon	Function	Method	Description
	Power On	Press Once	Turn on the device
	Power Off	Press Once	Turn off the device
	Dispense Water Once	Press Once	Dispense water for 30 seconds.
	Reset WiFi Connection	Press and hold for 3 seconds	Reset WiFi connection

## OPERATING THE DEVICE

The device can be powered either by direct power or wirelessly using the built-in rechargeable battery.

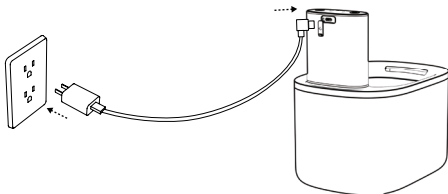

The battery requires 5 hours to be fully charged. The device can be use while it is charging.

The Battery Management System (BMS) will automatically stop charging the battery when it has reach full capacity.



**To extend the lifespan of the water pump, make sure the tank has enough water before powering it on to prevent it from pumping in air which causes slow water output and bubbles.**

## Power Saving Mode

The device will disable WiFi connection when it is operating wirelessly. Hence, the user will not have access to the Smart App interface.

However, the device will still be able to sent notification updates to the user's smartphone for the following status update:

- (1) Lack of Water
- (2) Low Battery

## Battery Management

 **Attention**

The battery is non-removable.  
Do not attempt to disassemble it.

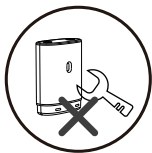

1. When low battery or low power is prompt, please charge the device as soon as possible to avoid affecting the battery life.
2. Avoid using the device below 5°C to avoid battery from degrading.
3. DO NOT expose the device to any direct heat source, including fire and direct sunlight.
4. Only use the accessories (adapter and cable) provided or following the device's specifications.
5. In the event the device will not be use for a long period of time, please charge the device until it is at full capacity before storing it away. Make sure to charge the device once every 6 months.
6. DO NOT dispose the device using fire, water or other liquids to avoid any explosive hazards.
7. DO NOT dispose the device as household waste. Please follow the local enviromental laws and regulations.
8. DO NOT heat (above 60°C) or incinerate the battery.

## Smart Motion Sensor

1. The device has a built-in smart motion sensor and dispenses water when it detects movement within a 180° degree angle and 60cm radius.

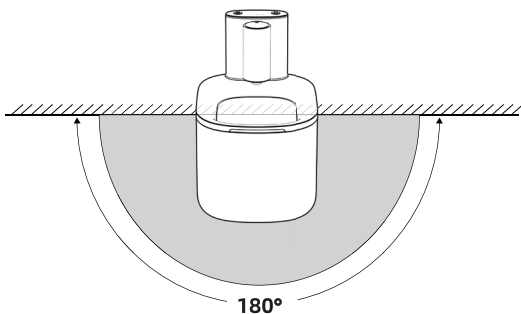

2. The back of the device is not able to detect movement. Hence, it's recommended to put the device against a wall.

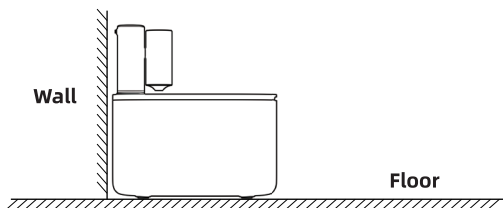

3. To attract pets to drink water, the device will automatically dispense water once every 2 hours.

## Filter Replacement

1. To avoid blockage inside the filter cartridge, **change the UF Filter Cartridge at least once a month**. When the filter change indicator is prompt, change the cartridge immediately.

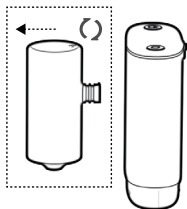

2. To keep the water clean and maintain hygiene, it's recommended to **clean the foam filter at least once a week and replace it every two weeks**.

If the room temperature is high and you have more than one pet using the device, you should wash **more frequently**.

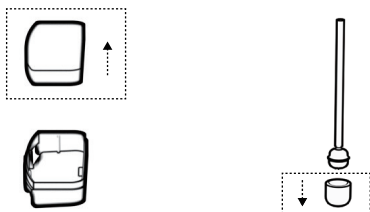

3. To avoid any potential risks caused by using filter from other sources, only use the filter set provided by Petea.

## Cleaning and Maintenance

1. To maintain cleanliness and hygiene, it's recommended to clean the whole device thoroughly once a week.
2. Make sure to remove the control hub before washing. The Control Hub should never be wash or rinse.
3. DO NOT use a dishwasher. Please wash by hand.
4. Dish soap can be used to clean the device.



Never wash or rinse  
the Control Hub.



## SPECIFICATIONS

Model	MINOM Plus
Power Adapter	Input: AC 100-240V 50/60Hz Output: 5V DC
Capacity	4L ( Optimal Capacity 3.5L/118oz)
Battery Capacity	5200mAh
Battery Type	Li-ion Battery Pack
Dimensions	238x172x151mm
Net Weight	866g/1.9lbs

# SMARTPHONE APPLICATION

This device can be bind and use on the following applications:

Smart Life



<https://smartapp.tuya.com/smartlife>

Tuya Smart



<https://smartapp.tuya.com/tuyasmart>

## Step 1. Download and Install

Please scan the QR code above to install the app or manually download 'Smart Life' or 'Tuya Smart' on Google Play or App Store.

## Step 2. Account Registration / Login

Create a new account by following the step by step on the app or login into an existing account.

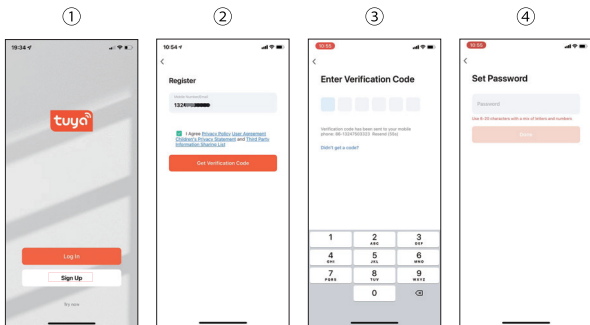

- ① Please open the "Tuyasmart" app and click "Sign up"  
② Please enter your email address and tick the app policy

- ③ Please input the verification code sent to your email address  
④ Please set up your login password

### Step 3. Device Configuration

Turn on **bluetooth** on your smartphone and make sure you are **connected to the 2.4Ghz WiFi**. The device does not support 5Ghz WiFi.

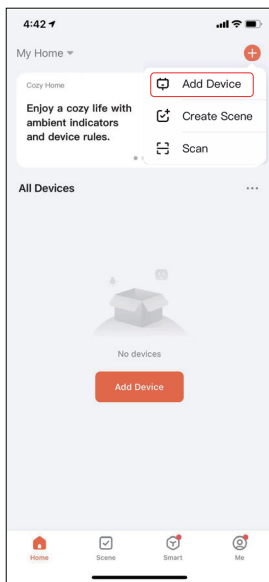

① After you log in, click "add device"

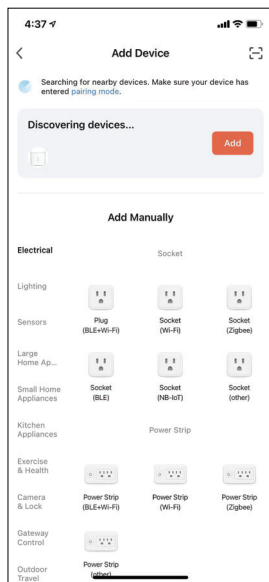

② Click the "add" button under 'discovering devices'.

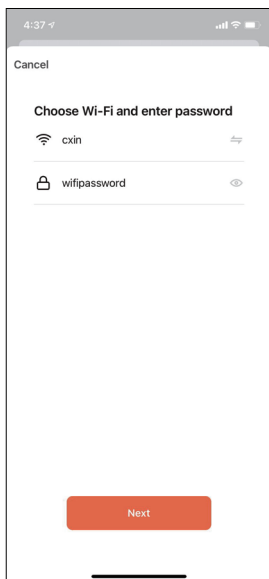

③ Enter WiFi details. Please make sure you are connecting to the 2.4Ghz WiFi. The device does not support 5Ghz.

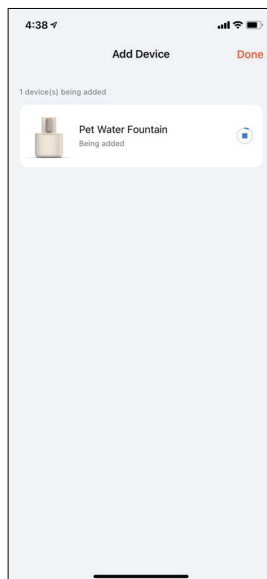

④ Wait a few minutes while the device is connecting to the WiFi.

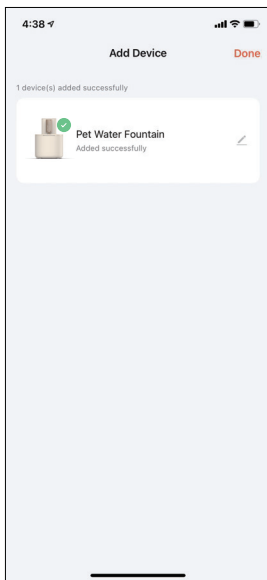

⑤ Device successfully added.

## Step 4. Interface Introduction

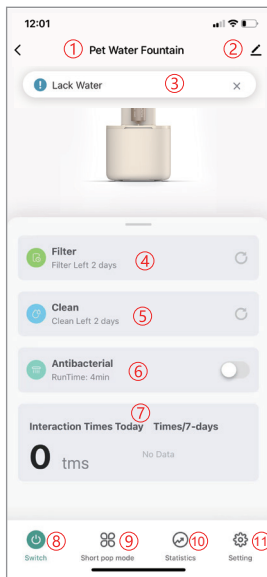
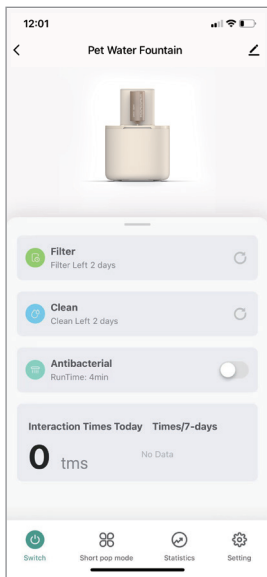

- ① Device name. It can be modified.
- ② Device information.
- ③ "Lack of water" and "Low battery" notification if there is low water and low battery.
- ④ Filter replacement reminder schedule
- ⑤ Cleaning reminder schedule
- ⑥ Antibacterial: To sterilise water inside the water tank. Adjusting the runtime to 4 minutes to achieve 100% sterilisation.

- ⑦ Drinking water data.
- ⑧ Turn on / off the device.
- ⑨ Two status: normal and smart.  
(On the smart mode the settings cannot be adjusted as they are based on the recommended values, whereas on the normal mode the settings can be adjusted to your preferences).
- ⑩ Statistics
- ⑪ Setting

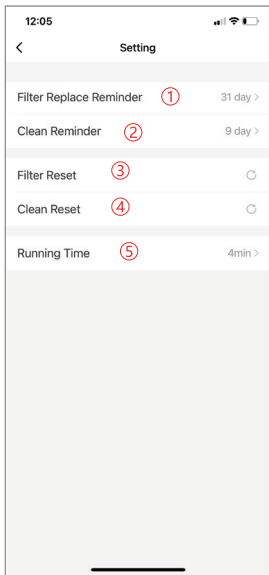

- ① Set filter replacement time
- ② Set cleaning time
- ③ After replacing filter, click the button to restart timer
- ④ After cleaning the device, click the button to restart timer
- ⑤ Change the runtime.

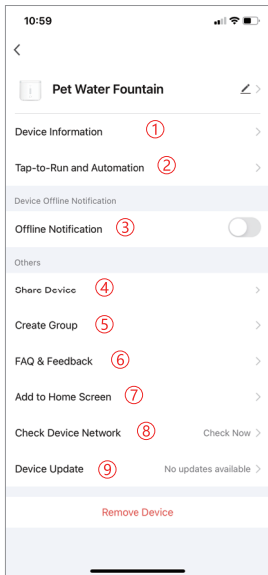

- ① View device ID, IP address, MAC, time zone and signal.
- ② Tap-to-Run and Automations.
- ③ Turn on Offline Notification to be notified when the device is offline.
- ④ Share the device with other accounts.
- ⑤ Create group of smart devices.
- ⑥ FAQ & Feedback
- ⑦ Adddevice to Home Screen.
- ⑧ Check Device Network.
- ⑨ Device software updates.
- ⑩ Remove device will delete the WiF information from the device. Then use a new account to connect.

## TROUBLESHOOTING

Problem	Solution
<p>The device does not dispense water or dispense slowly with a lot of bubbles.</p>	<ol style="list-style-type: none"><li>1. Please make sure the tank has enough water.</li><li>2. Then reboot the device to see if it works normally.</li><li>3. Please reinstall the filter cartridge.</li></ol>
<p>The water tank is dirty. The foam filter is dirty. The interior of the water tank / water tray is sticky.</p>	<p>Clean the device and change the filter regularly.</p> <ol style="list-style-type: none"><li>1. Change the filter cartridge at least once a month.</li><li>2. Change the foam filter at least once every two weeks.</li><li>3. Clean the device thoroughly at least once a week.</li><li>4. If the room temperature is high or if you have more than one pet using the device, please do cleaning and change filter more frequently.</li></ol> <p>Refer to Cleaning and Maintenance for more details.</p>
<p>The device does not charge. Battery life is not as expected. The device would not turn on.</p>	<ol style="list-style-type: none"><li>1. Do not place the device in area with high activity to reduce frequent motion detection and power consumption.</li><li>2. Please use the provided power cable and adapter to charge the device.</li><li>3. To avoid potential safety hazards, do not dismantle the device.</li></ol>

## **FCC Statement**

The device complies with Part 15 of the FCC Rules.

Operation is subjected to the following conditions:

- (1) this device may not cause harmful interference, and
- (2) this device must accept any interference received, including interference that may cause undesired operation.

Changes or modifications to this device not approved by the party responsible for compliance could void the user's authority to operate the equipment.

### **NOTE:**

This equipment has been tested and found to comply with the limits for a Class B digital device, pursuant to Part 15 of the FCC Rules. These limits are designed to provide reasonable protection against harmful interference in a residential installation. This equipment generates, uses and can radiate radio frequency energy and, if not installed and used in accordance with the instructions, may cause harmful interference to radio communications. However, there is no guarantee that the interference will not occur in a particular installation. If this equipment does cause interference to radio or television reception, it can be determined by turning the device off and on.

# WARRANTY

## One (1) Year Limited Warranty

### Warranty Registration

Register your warranty by scanning the QR code or go to [petea.my/warranty](https://petea.my/warranty).

Keep your receipt/order details for future reference. We will request additional documentation if your information does not tally with our database.



<https://petea.my/warranty>

### Warranty Claims

To claim your warranty, please contact us via WhatsApp (03-6734 2588). You can also scan the QR code to be redirected to our WhatsApp.

Provide a detailed description of the problem you are facing. We will get back to you within 48 hours.



#### Important Notice:

**In the event your information does not tally with our database, Petea will request additional documentation/proof of purchase. Petea has the right to reject warranty claims that fails to provide the necessary documentation.**

## **Terms and Conditions**

### **What is covered by this warranty?**

Petea-branded Products (excluding accessories) are warranted against manufacturing defects in material and workmanship for a period of ONE (1) YEAR from the date of purchase.

### **What is not covered by this warranty?**

This Warranty does not apply to accessories (such as cables, adapter and plug) and excludes cosmetic defects and damage resulting from abuse, negligence, accident, modification, unauthorised repairs or other causes that are not defects in materials and workmanship.

### **What will Petea do in the event warranty is breached?**

If a defect arises during the Warranty Period, Petea will:

- (1) repair the device free of charge using new parts or previously used genuine parts that have been tested and passed functional requirements, or
- (2) exchange the device with a replacement of the same model (or with your consent a device that has the same or substantially similar features as the original product) that is new or comprised of new and/or previously used genuine parts and has been tested and passed functional requirements.

A replacement part or Petea Product resumes the remaining term of the Warranty or sixty (60) days from the date of replacement or repair, whichever provides longer coverage for you.

### **Warranty Service Options**

Petea will provide warranty service through one or more of the following options:

- (i) Carry-in service. You may return your Product to Petea Repair Centre.
- (ii) Mail-in service. You may ship your Product to Petea Repair Centre. You will bear the shipping cost to Petea and Petea will bear the return shipping cost to your location.
- (iii) Do-it-yourself (DIY) parts service. DIY parts service allows you to service your own Product.

# petea

Website  
**petea.my**



**peteacompany**

WhatsApp



(+6) 03 6734 2588



This device complies with Part 15 of the FCC Rules. Operation is subject to the following two conditions: (1) this device may not cause harmful interference, and (2) this device must accept any interference received, including interference that may cause undesired operation.

---